

# TECHNICAL INSTALLATION MANUAL

## HYDRAULIC BOLLARD COLUMN

# MOLE

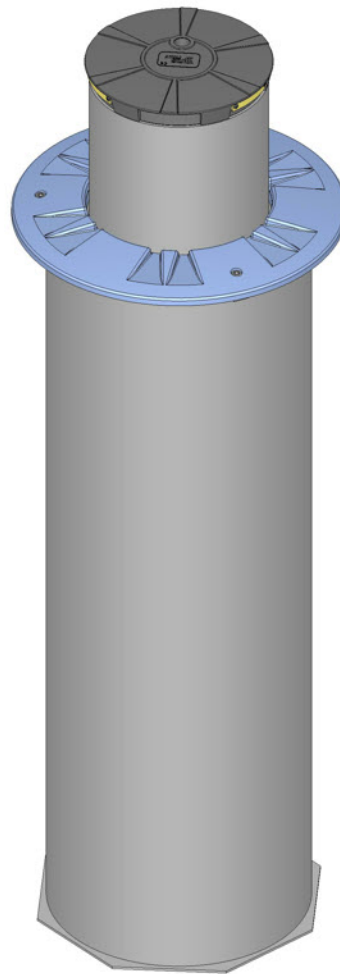

**WARNING!!** Before installing, thoroughly read this manual that is an integral part of the pack

Our products if installed by qualified personnel capable to evaluate risks, comply with norms UNI EN 12453, EN 12445



The CE mark conforms to European directive  
EEC 89/336 + 92/31 + 93/68 D.L. 04/12/1992 N. 476.

## DIMENSIONS

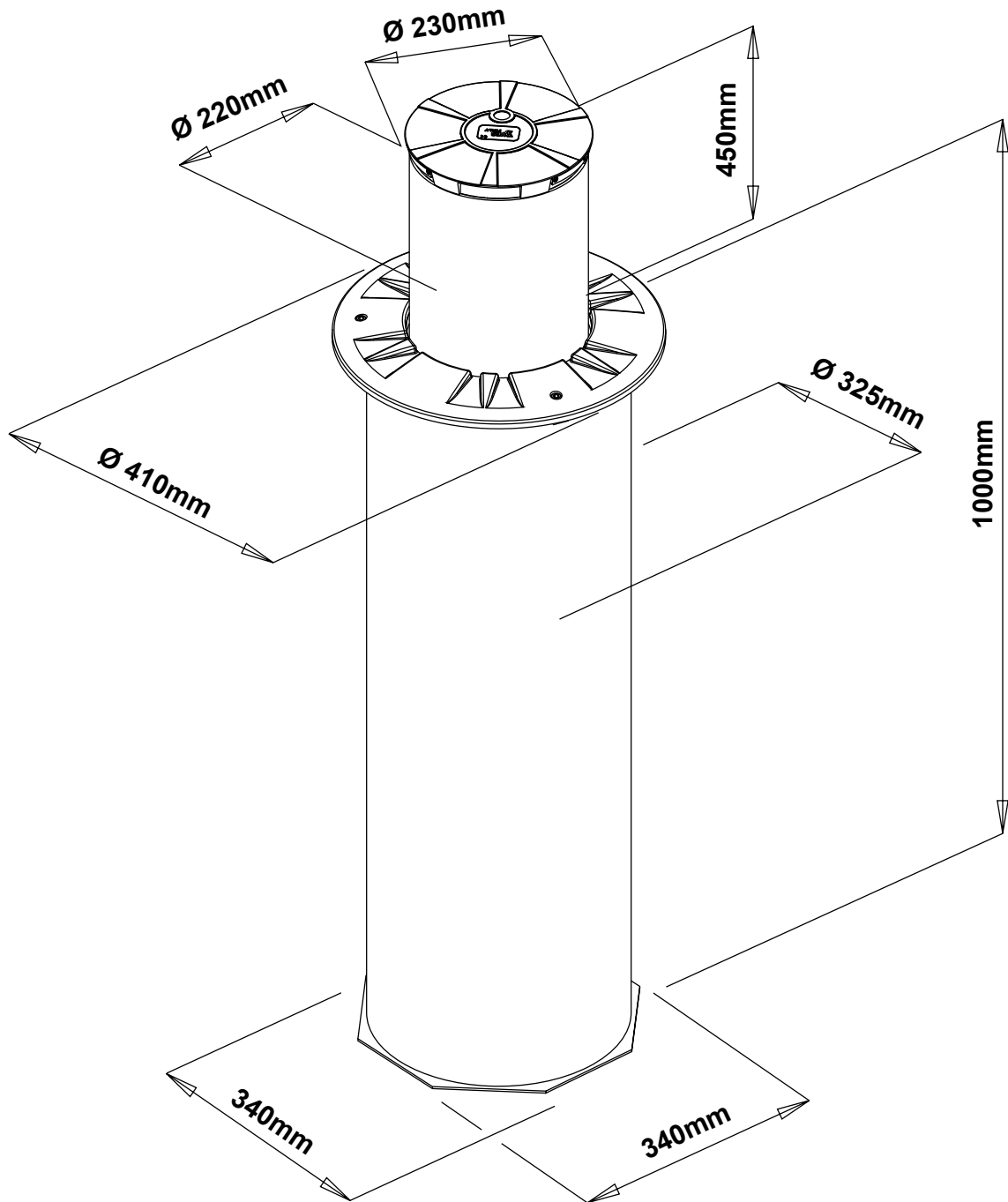

## TECHNICAL DATA

Motors power supply	230 Vac	Time of opening or closing	7 sec
Motor current input	250 W	Bollard stroke	450 mm
Motor RPM	1400	Motor current input	1 A
Condenser	12.5 $\mu\text{F}$	Weight tube of foundation	35 Kg
Working temperature	-20° C / +55° C	Weight bollard internal	45 Kg
Led power supply	24 Vac		
Protection rating	IP66		

---

## CONSIDERATIONS FOR INSTALLATION

---

- The installation and testing operations must be performed solely by qualified personnel in order to guarantee the proper and safe operation of the automatic gate.
- The company declines any responsibility for damage caused by incorrect installations due to incompetence and/or negligence.

---

## METHOD INSTALLATION

---

Create an excavation in the ground of an adequate size to hold the tube outside of the bollard and prepare the trunking and drainage for the water inside the holes on the bottom of the tube.

Level and cement.

***IMPORTANT: It mandatory for correct operation automation prepare water drainage***

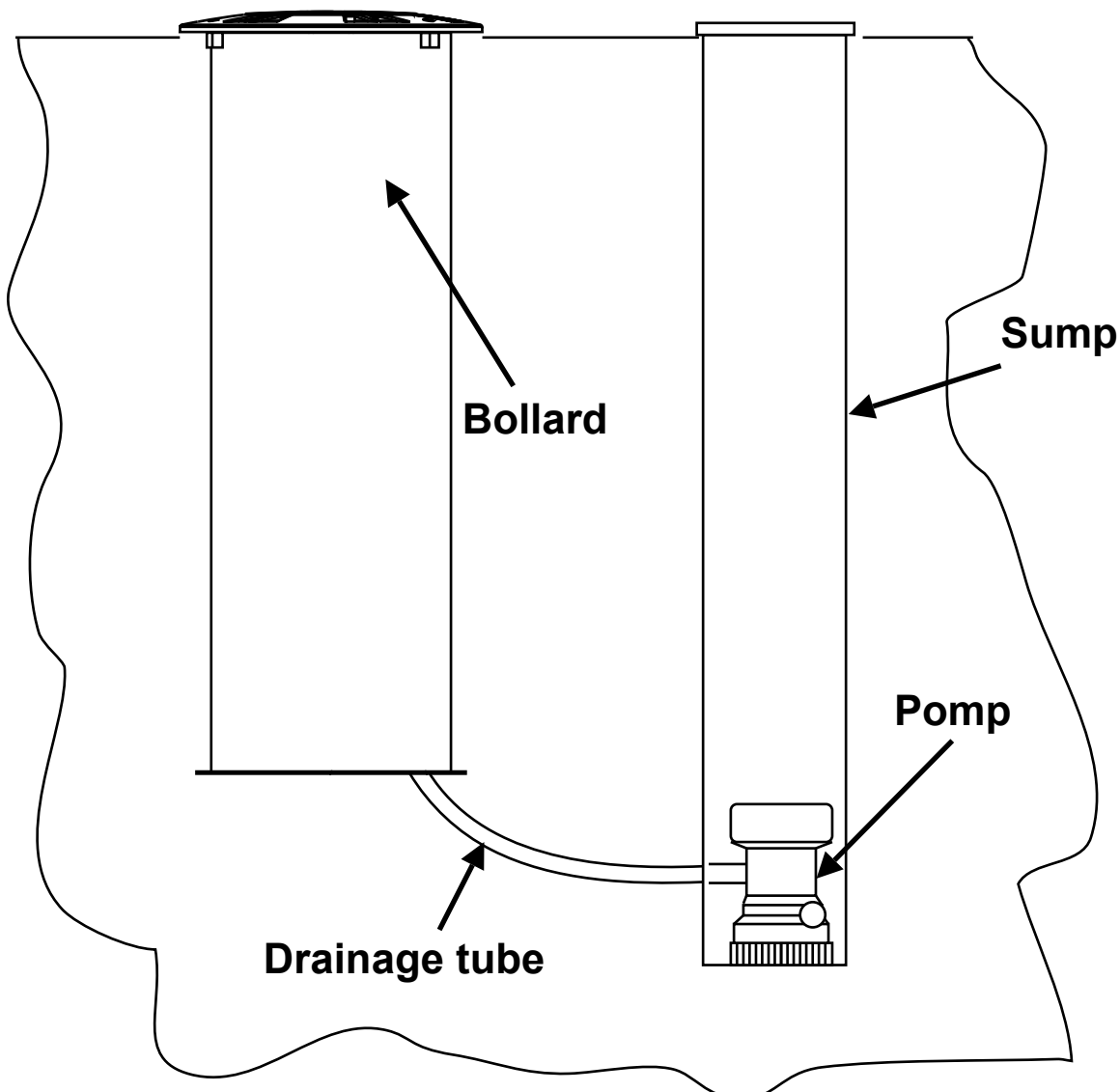

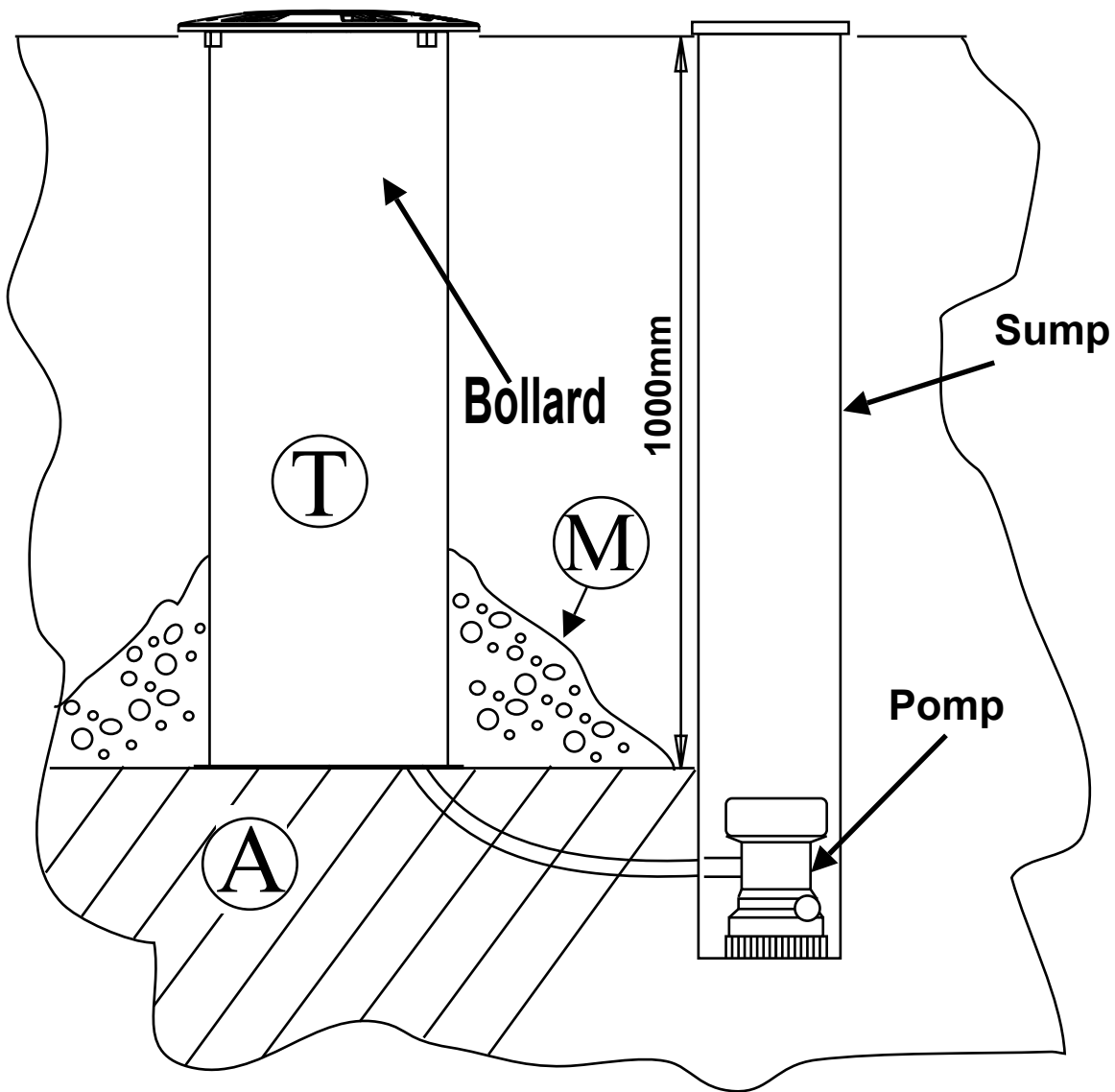

## WORK PHASES

- *Implement the plan A to about 1mt depth from the surface*
- *Lock the tube T through weak-mix concrete M*
- *Check the lead and level*
- *Put cement*

# INSTALLATION BOLLARD (If provided separate from the

- Enter the bollard letting the wheels in the tube.

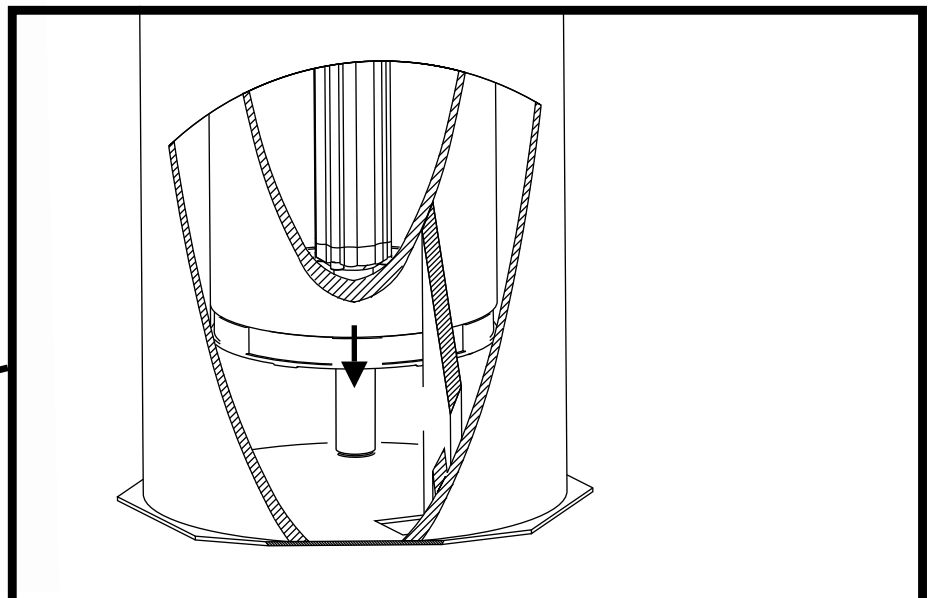
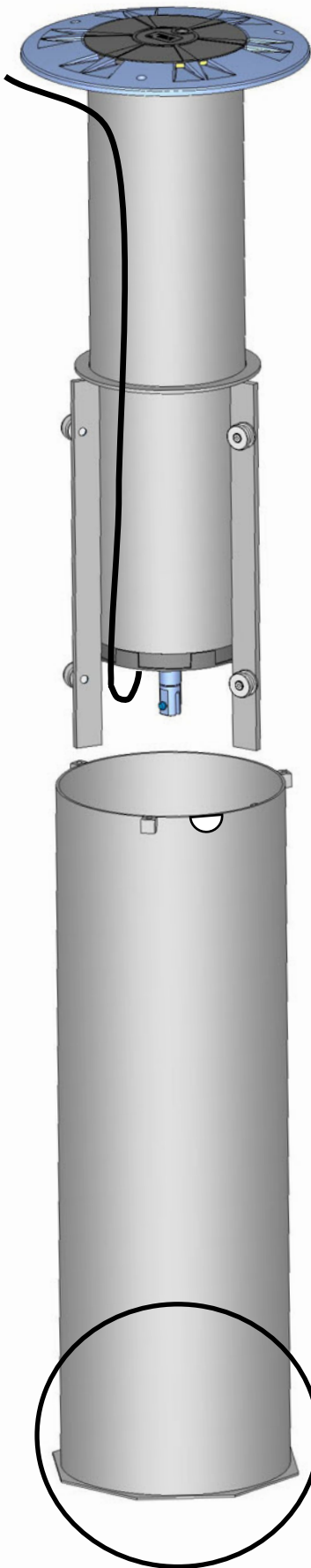

- The cable outside the from the hole.
- Place on the top cover of cast iron pipe and secure it with screws.

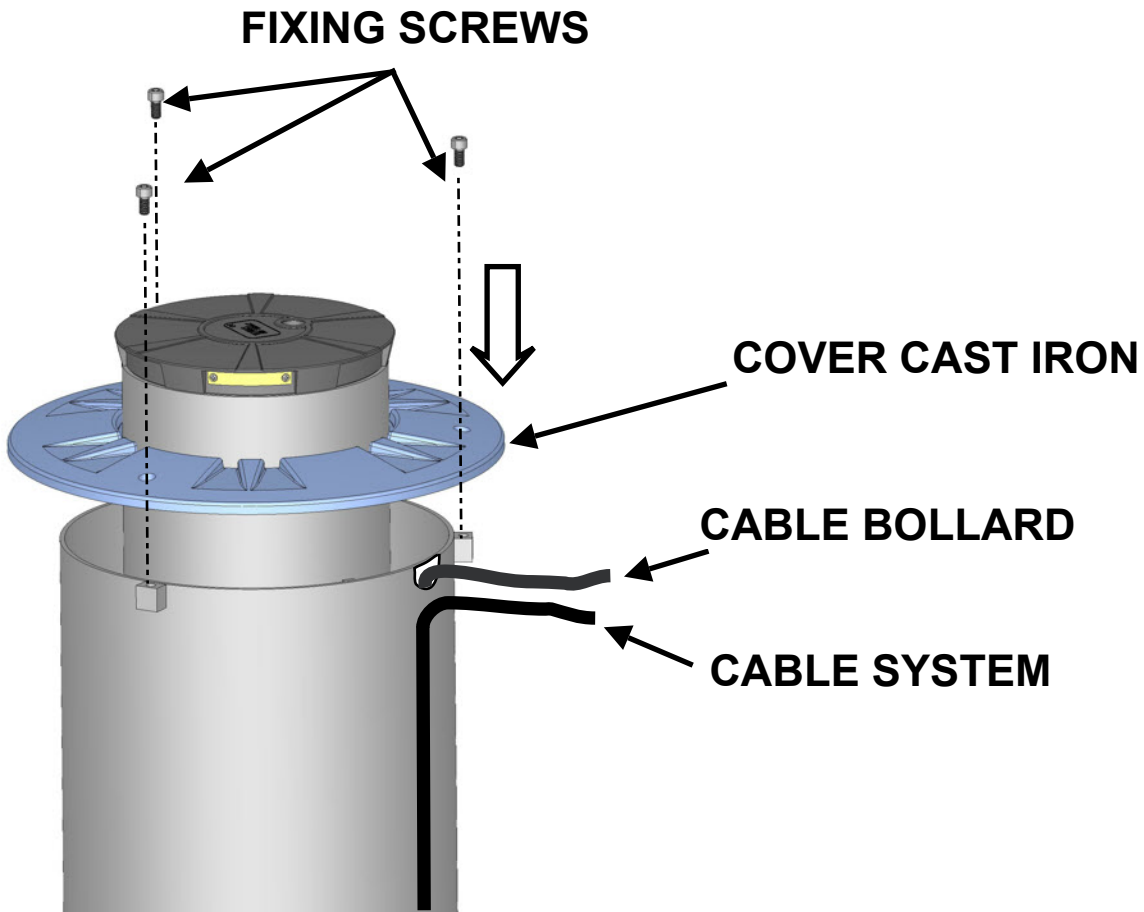

- Make electrical connections using a sealed housing making the resin coating to make the electrical waterproof.

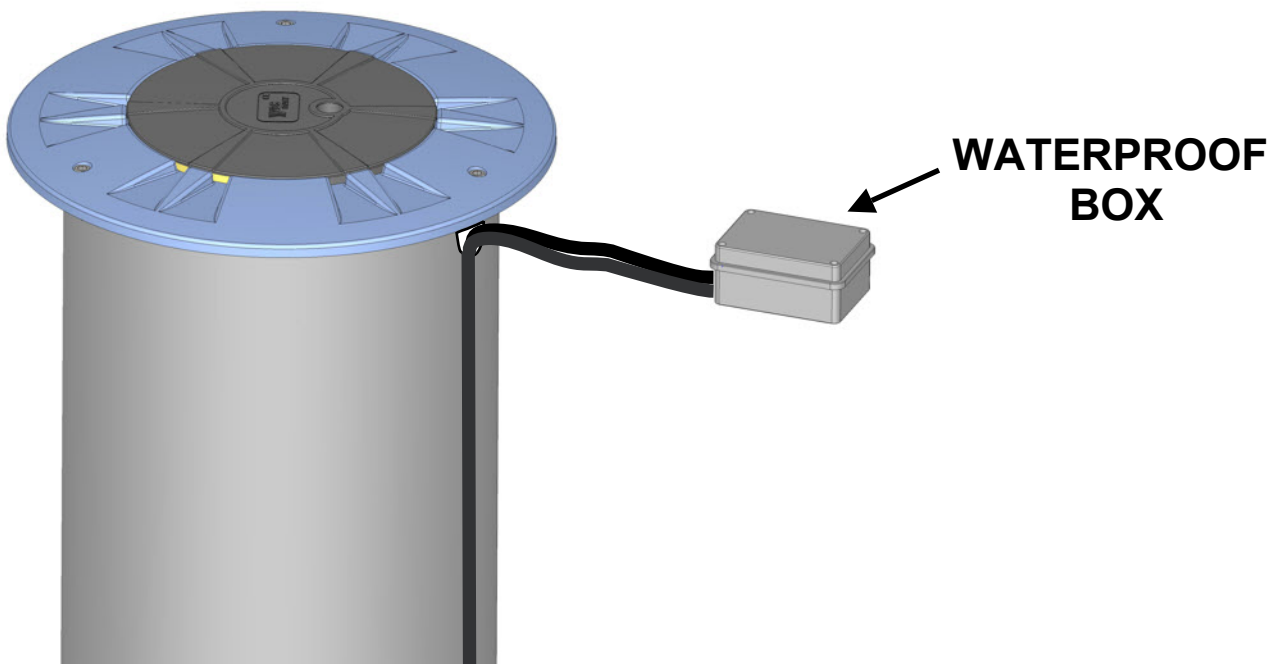

---

# ELECTRICAL CONNECTION

---

POWER ENGINE

POWER LED  
12/24Vac/dc

ROSE | -

RED | +

BLU= COMMON

GREEN =LOWER OR OPEN

WHITE =RAISE OR CLOSE

GREY= COMMON

GROUND  
YELLOW

## CABLE BOLLARD

### NOTE:

FOR CLOSED AUTOMATION MEANS THE BOLLARD RAISED

### EMERGENCY RELEASE

- Insert the key into the seat located on the bollard.
- Turn the key clockwise until full release.
- Put pressure on the bollard and lower.
- To lock again, turn the key counterclockwise without
- Protrude from the pin release plan of the bollard.

**CAUTION DO NOT LOOSEN OR REMOVE ALL THE CAP CAN CAUSE OF WATER INFILTRATION**

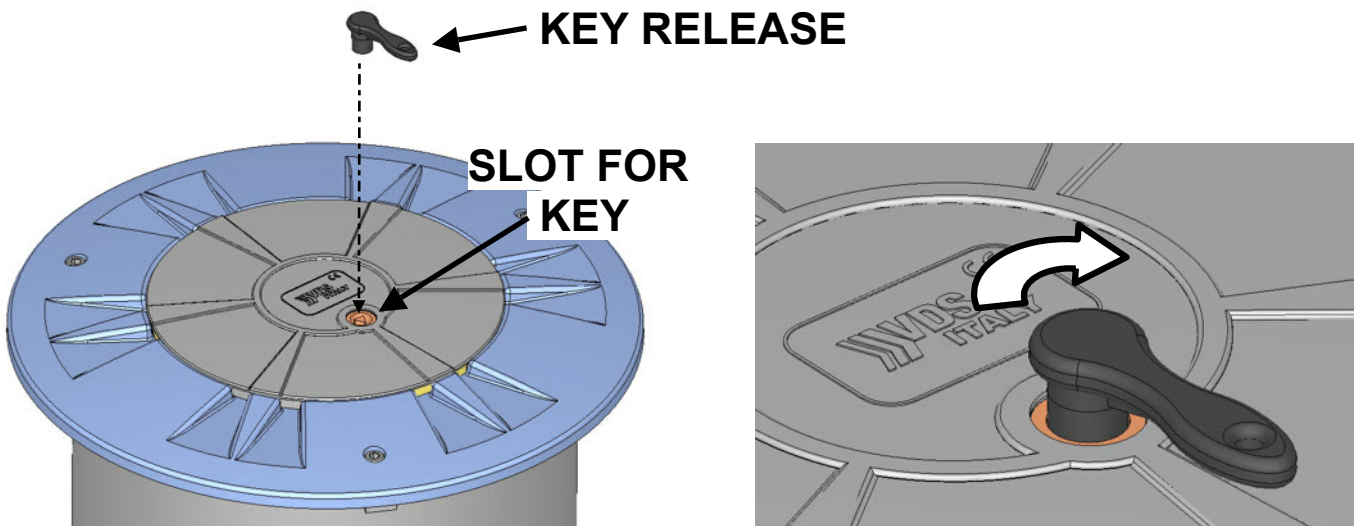

## TROUBLESHOOTING

PROBLEM	PROBABLE CAUSE	SOLUTION
On giving a command with the remote control or with the key-switch, the automation doesn't open or the motor doesn't start	230 volt mains voltage absent	Check master switch
	Emergency STOP present	Check for any STOP selectors or commands. If not used, check jumper on STOP contact input on the control board
	Fuse blown	Replace with one of same value.
	Power cable of motor or motors not connected or faulty.	Connect the cable to appropriate terminal or replace.
	The photocell is not functioning or the beam is interrupted	Check the connection, remove any obstacle across the beam
On giving a command with the remote control, the automation doesn't open but works with the key command	The remote control has not been memorised or the battery is flat	Carry out the remote control learning procedure on the radio receiver or replace the battery with a new one..
The automation starts, but stops immediately	The force of the motor or motors is insufficient	Modify the value with the FORCE trimmer on the control unit

**N.B. - If the problem persists, contact your Retailer or the nearest Service Centre**

All products are guaranteed for 2 years, as per the date on the invoice or on the receipt.

The warranty also does not include: failures or damages caused by faults of the electrical system and/or carelessness, negligence or inadequacy of the installation to the use for which it is intended and in any case from abnormal use; failures or damages due to tampering by unauthorized personnel or the use of components not attributable to the manufacturer and/or non-original spare parts; defects caused by chemical agents, external bodies or atmospheric and/or natural phenomena in general; failures or damages caused by incorrect installation of the Products according to the rule of art, safety and conformity of use expressly indicated in the technical documentation of the same Products; the consumables; interventions for checks and assessments of any flaws or defects then not found; compensations for the period of inactivity of the system where the Products are installed.









## **SAFETY PRECAUTIONS**

These warnings are an essential, integral part of the product and must be given to the user. They provide important indications on the installation, use and maintenance and must be read carefully. This form must be preserved and passed on to subsequent users of the system. The incorrect installation or improper use of the product may be dangerous.

## **INSTALLATION INSTRUCTIONS**

- The installation must be performed by professionally skilled personnel and in compliance with current local, state, national and European legislation.
- Before beginning the installation, check the integrity of the product.
- The laying of cables, electrical connections and adjustments must be workmanlike performed.
- The packing materials (cardboard, plastic, polystyrene, etc.) are a potential hazard and should be disposed of correctly and not left within reach of children.
- Do not install the product in potentially explosive environments or environments disturbed by electromagnetic fields. The presence of inflammable gases or fumes is a grave danger to safety.
- Set up a safety device for overvoltage, a disconnecting and/or differential switch suitable for the product and conforming to current standards.
- The manufacturer declines any and all responsibility for product integrity, safety and operation in the event incompatible devices and/or components are installed.
- Solely original spare parts should be used for repairs and replacements.
- The installer must provide all the information relating to the operation, maintenance and use of the individual parts, components and system as a whole.

## **WARNINGS FOR THE USER**

- Read the instructions and enclosed documentation carefully.
- The product must be used for the express purpose for which it was designed. Any other use is considered improper and therefore hazardous. In addition, the information given in this document and in the enclosed documentation may be subject to modifications without prior notice. It is given as an indication only for product application. The company declines any responsibility for the above.
- Keep products, devices, documentation and anything else provided out of reach of children. In the event of maintenance, cleaning, breakdown or faulty operation of the product, cut off the power and do not attempt to operate on the product. Contact solely the professionally skilled personnel responsible for these operations. Failure to adhere to the above indications may be dangerous.

**The data and images are for guidance only**

**VDS reserves the right to change at any time characteristics of the products described in its sole discretion, without notice.**



**Via Circolare p.i.p. N° 10  
65010 Santa Teresa di Spoltore (PE) - ITALY  
Tel. +39 085 4971946 - FAX +39 085 4973849  
www.vdsautomation.com - info@vdsautomation.it**